

## End Fixing

Ideal for looping around purlins, beams, roof trusses and other suitable building features

### FEATURES / BENEFITS

- Hanger using a non-invasive, simple choke-knot technique
- No need for nuts, bolts, clamps or other accessories
- Up to 6 times faster installation compared with threaded rod or chain
- Available for use with No.1 - No.5 hangers with up to 5:1 safety factor
- Comes as a ready-to-use kit with wire rope and Gripple hanger
- Available in lengths from 1 m to 10 m (other lengths available upon request)
- Independently certified
- Also available in Stainless Steel



### INSTALLATION

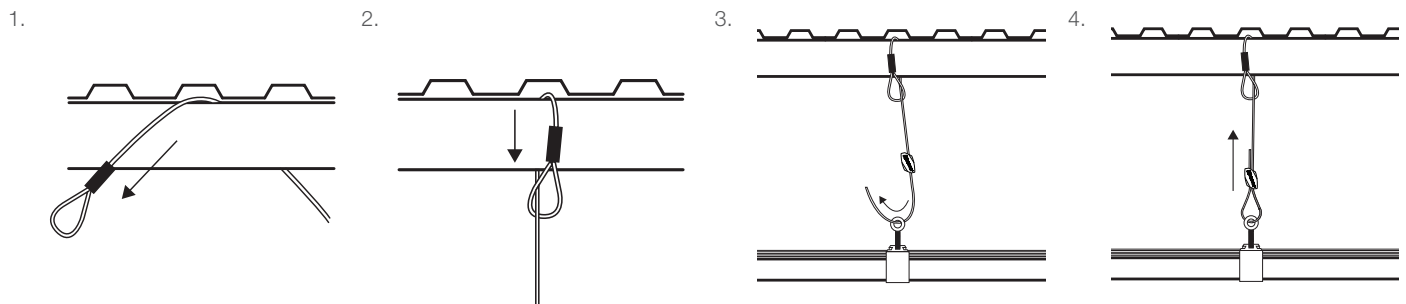

### SPECIFICATION

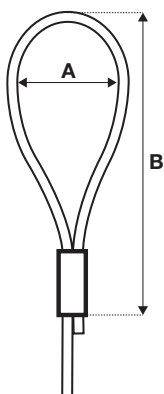

Size	A (mm) indicative	B (mm) indicative	Wire rope diameter (mm)
No. 1	30	60	1.5
No. 2	30	60	2.0
No. 3	25	60	3.0
No. 4	45	85	4.75
No. 5	45	90	6.0

### SUBMITTAL INFORMATION

#### Safe Working Load:

Refer to hanger load ratings and safe working loads.

#### Material:

Wire rope – Galvanised High Tensile Steel (EN12385)

Ferrule – Aluminium

#### Approvals:

Lloyds certified and third party fire tested

### AVAILABLE HANGERS

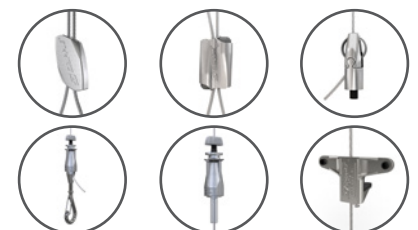

For more options on available hangers please contact us or visit [www.gripple.com](http://www.gripple.com)

### IMPORTANT RECOMMENDATIONS

1. Construction materials and conditions vary on different sites. If it is suspected that the base material has insufficient strength to achieve a suitable fixing, contact Gripple Ltd. The responsibility for judgement of base material strength lies with the installer, and not with Gripple Ltd.
2. Not to be used in marine, coastal or corrosive environments.
3. The information and recommendations given herein are believed to be correct at time of writing. The data has been obtained from tests done under laboratory, or other controlled conditions and it is the user's responsibility to use the data given in light of conditions on site, taking account of the intended use of the products concerned.
4. Whilst Gripple Ltd can give general guidance and advice, the nature of Gripple products means that the ultimate responsibility for selecting the correct product for a particular application must lie with the customer.
5. All products must be used, handled and applied in accordance with current product instructions and manufacturers recommendations for use, published by Gripple Ltd.

PI-LOOP-ENG-1540

[www.gripple.com](http://www.gripple.com)

Gripple's policy is one of continuous development and innovation. We therefore reserve the right to alter specifications, etc. without notice.



Gripple Ltd | The Old West Gun Works | Savile Street East | Sheffield S4 7UQ  
Tel 0800 018 4264 Fax 0114 275 1155 Email [info@gripple.com](mailto:info@gripple.com)