

## End Fixing

For fast, quarter turn attachment to Low Profile or Universal Brackets

### FEATURES / BENEFITS

- Quick** – fast, quarter turn attachment to Gripple Brackets
- Multi-use** – allows for suspension of services from pre-installed header rails or to provide multi-tier suspension from Gripple Universal Brackets
- Safe** – fail safe clip to secure into bracket - prevents unexpected movement
- Compatible** – available for use with No. 1, No. 2 and No. 3 hangers
- Ready-to-use** – supplied as a kit with wire and Gripple Hanger
- Versatile** – available in lengths from 1 to 10 m
- Bespoke** – other lengths are available on request



### INSTALLATION

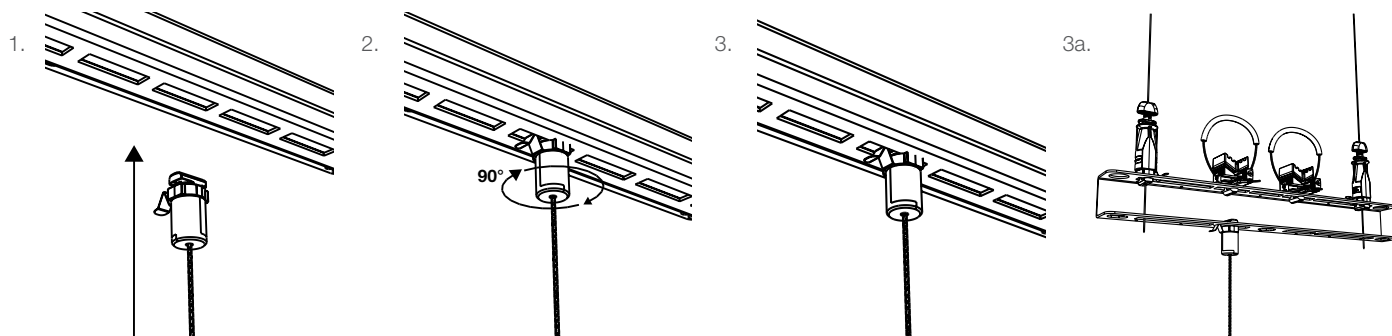

### SPECIFICATION

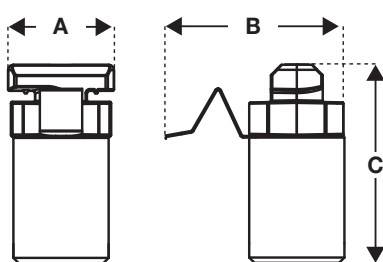

Size	A (mm)	B (mm)	C (mm)
No. 1	20	34	37.5
No. 2	20	34	37.5
No. 3	20	34	37.5

### SUBMITTAL INFORMATION

#### Safe Working Load:

Available for use with No.1, No. 2 and No. 3 hangers. Refer to hanger load ratings and safe working loads.

#### Material:

**Body** – Mild Steel 230M07PB (EN1A Leaded)

**QT Adaptor** – Zinc Alloy (EN12844 ZP2)

**Spring Clip** – Stainless Spring Steel  
BS5770 301 S21

### AVAILABLE HANGERS



For more options on available hangers please contact us or visit [www.gripple.com](http://www.gripple.com)

### IMPORTANT RECOMMENDATIONS

- Construction materials and conditions vary on different sites. If it is suspected that the base material has insufficient strength to achieve a suitable fixing, contact Gripple Ltd. The responsibility for judgement of base material strength lies with the installer, and not with Gripple Ltd.
- Not to be used in marine, coastal or corrosive environments including swimming pools and chlorinated environments.
- The information and recommendations given herein are believed to be correct at time of writing. The data has been obtained from tests done under laboratory, or other controlled conditions and it is the users responsibility to use the data given in light of conditions on site, taking account of the intended use of the products concerned.
- Whilst Gripple Ltd can give general guidance and advice, the nature of Gripple products means that the ultimate responsibility for selecting the correct product for a particular application must lie with the customer.
- All products must be used, handled and applied in accordance with current product instructions and manufacturers recommendations for use, published by Gripple Ltd.

PI-QTBARREL-ENG

[www.gripple.com](http://www.gripple.com)

Gripple's policy is one of continuous development and innovation. We therefore reserve the right to alter specifications, etc. without notice.



Gripple Ltd | The Old West Gun Works | Savile Street East | Sheffield S4 7UQ  
Tel 0800 018 4264 Fax 0114 275 1155 Email [info@gripple.com](mailto:info@gripple.com)