

# Drop-in Anchor

**GRIPPLE®**

Accessory

Punch activated drop-in anchor for fixing into concrete and hollow-core ceiling slabs.

## FEATURES / BENEFITS

- Shallow embedment depth
- The fixing is flush to the surface after setting
- Flanged, suitable for use in hollow core concrete
- Setting tool leaves a visible impression for easy inspection of correct installation
- Supplied as standard with all stud kits, also accepts pigtail anchor bolts
- Available in M6 (25 mm), M8 (30 mm) and M10 (40 mm)
- Easily installed using hammer-in Setting Punch
- ETA Approved

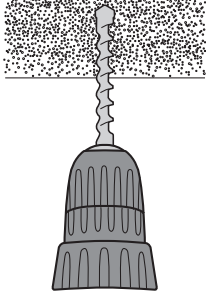

## INSTALLATION

- 

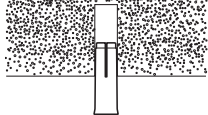
1. Drill a hole and clear with a wire brush
- 

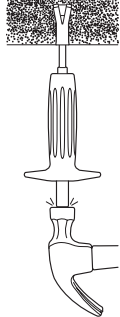
2. Push in anchor
- 

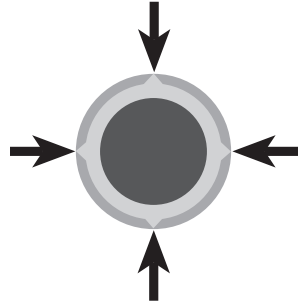
3. Set using appropriate sized setting punch
- 

4. Correct installation shows visible markings

## SPECIFICATION

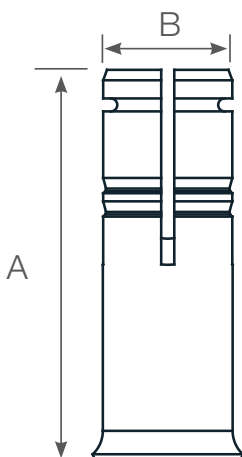

Size	A	B
M6	25	Ø 8
M8	30	Ø 10
M10	40	Ø 12

## SUBMITTAL INFORMATION

### Safe Working Load:

The indicated load value applies to non-cracked concrete C20/25, no edge distance or spacing influence.

M6 = 200 kg, M8 = 500 kg and M10 = 750 kg

No safety factor applies

### Material:

Steel (Electro galvanised finish)

### Approvals:

ETA-06/0047

## IMPORTANT RECOMMENDATIONS

1. Construction materials and conditions vary on different sites. If it is suspected that the base material has insufficient strength to achieve a suitable fixing, contact Gripple Ltd. The responsibility for judgement of base material strength lies with the installer, and not with Gripple Ltd.
2. Not to be used in marine, coastal, swimming pool or corrosive environments.
3. The information and recommendations given herein are believed to be correct at time of writing. The data has been obtained from tests done under laboratory, or other controlled conditions and it is the user's responsibility to use the data given in light of conditions on site, taking account of the intended use of the products concerned.
4. Whilst Gripple Ltd can give general guidance and advice, the nature of Gripple products means that the ultimate responsibility for selecting the correct product for a particular application must lie with the customer.
5. All products must be used, handled and applied in accordance with current product instructions and manufacturers recommendations for use, published by Gripple Ltd.